

NORTH POINT CABINETRY®



Thoughtfully Designed, Carefully Crafted



NorthPoint Cabinetry boasts a wide array of high-quality cabinet combinations allowing you to design the perfect kitchen or bath that works for your family’s lifestyle. Make the kitchen or bath high-functioning and stunningly beautiful by adding Hardware Resources’ vast selection of cabinet organizers, LED cabinet lighting, and knobs and pulls.

Table of Contents

- Our Collections 2-3
- Quality Comes First. 4-7
- Expert Finishing 8-9
- Our Door Styles
 - Catalina 12-27
 - Maui. 28-31
 - Hatteras 32-39
- Versatile Vanity Cabinets 40-43
- Cabinets for Any Space 44-47
- Personalize Your Space
 - Moulding 48-49
 - Fillers & Panels 50-51
 - Design Elements 52-53
 - Specialty Cabinets 54-55
- The Finishing Touches
 - Decorative Cabinet Hardware 58-65
 - Cabinet Organizers 66-71
 - Stainless Steel Sinks 72-73
 - Cabinet Lighting 74-79
- Manufacturing & Technical Information
 - Cabinet Breakdown 80-81
 - Cabinet Lineup 82-83
 - What are QuickBuild® Cabinets? 85

ON THE COVER
Perimeter Cabinets:
 Catalina Sandstone
Island Cabinets:
 Catalina Sage Green
Decorative Cabinet Hardware:
 Ivan Collection in Matte Black



Perimeter Cabinets: Catalina Polar White

Island Cabinets: Catalina Slate

Decorative Cabinet Hardware: Key Grande Collection in Matte Black with Satin Nickel

Our Collections



PREMIER Collection

Pages 12 – 31

The Premier Collection features elegant upgrades like soft-close doors and drawers that won't slam when closed.

Door Styles: Catalina, Maui

- High-quality wood construction
- 3/4" thick shelves
- Beautiful, finished interior
- 5-Year limited warranty

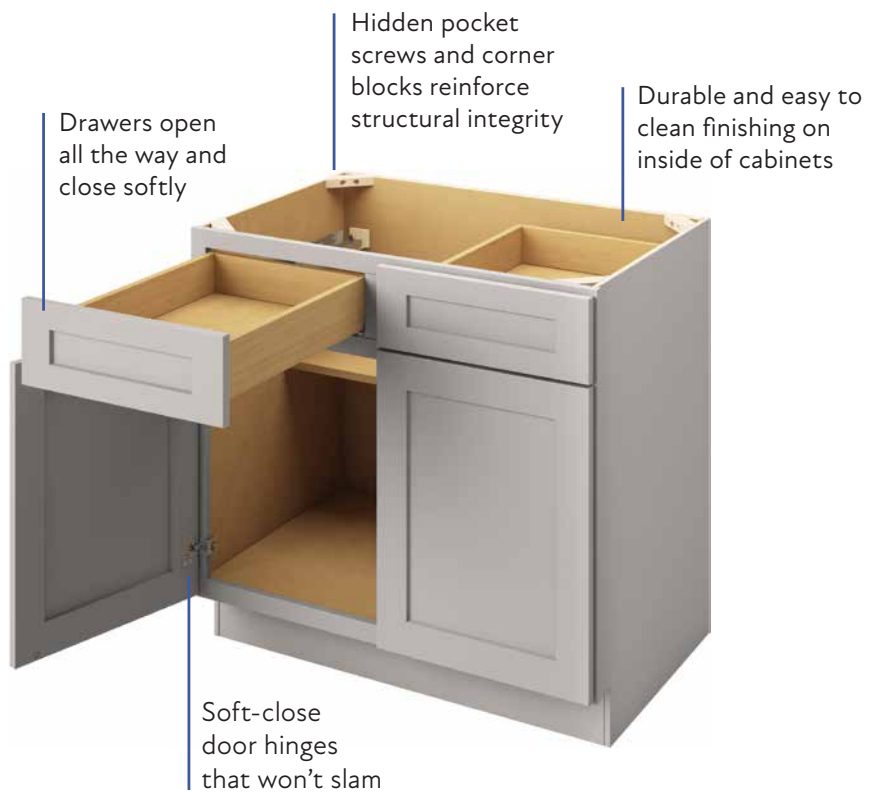



ESSENTIALS

Collection

Pages 32 – 39

The Essentials Collection features reliable hardware and sturdy construction that create a quality cabinet at a great value.

Door Style: Hatteras

- High-quality wood construction
- 3/4" thick shelves
- Beautiful, finished interior
- 1-Year limited warranty



Quality Comes First

Your choice of cabinetry makes a personality-defining statement in your home. Selecting the right cabinets is an important first step because your cabinets should be just as functional on the inside as they are beautiful on the outside. Cabinets should withstand the demands of daily use and maintain their integrity throughout their lifetime.

That's why quality comes first at NorthPoint Cabinetry. Every detail is carefully considered to ensure our cabinets not only meet our high quality standards, but yours as well. Our commitment to quality combined with our on-trend finishes, door styles, and product depth and breadth are what make NorthPoint Cabinetry the perfect choice for your project.

IT STARTS WITH QUALITY WOOD

Just as a healthy tree needs strong roots to thrive, a quality cabinet requires premium lumber at its core. The quality of wood is of utmost importance, so our cabinets feature all-wood construction.



STRUCTURAL INTEGRITY

Meaningful yet hidden reinforcements—like solid wood corner blocks and strategically placed pocket screws—help reinforce the structural integrity of the cabinet. Take comfort that these well-constructed cabinets will stand the test of time.

THOUGHTFUL CRAFTSMANSHIP

These cleverly designed cabinets boast an innovative dovetail and hidden pocket screw construction that provides robust quality and quick, accurate assembly.





PRETTY ON THE INSIDE, TOO

NorthPoint Cabinetry features a clean and beautifully finished birch interior that enhances the cabinet's luxurious, high-quality appeal.

PREMIUM DRAWER BOXES

Dovetail joinery is the hallmark of high-quality drawer boxes. The UV finish of the drawer, dovetail construction, and smooth concealed slides are synonymous with quality furniture.





HARDWORKING HARDWARE

Our cabinets feature discreet compact hinges and concealed undermount slides. The hinges and slides have been third-party tested and exceed industry standards. The Premier Collection (shown) features full extension slides, allowing for easy access and use of the whole drawer.

STURDY SHELVES

NorthPoint Cabinetry shelves are constructed from an impressive 3/4" thick veneered plywood, preventing sagging over time under the weight of normal use. Shelf height is adjustable, so the homeowner can optimize storage space.

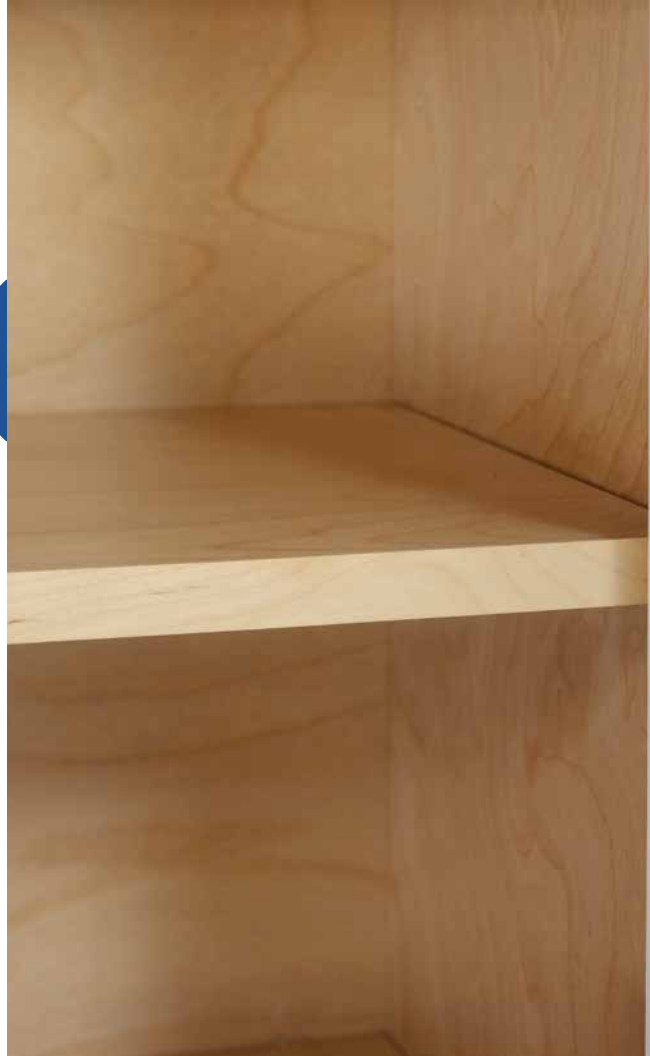

Expert Finishing

Count on consistent, high-quality finishing. Our state-of-the-art manufacturing facility utilizes a multi-step professional finishing process. This meticulous process maintains a high degree of color and application accuracy from cabinet to cabinet, ensuring a beautiful run of cabinets when installed.



CATALINA FINISHES



POLAR WHITE
(PAINTED)



NEW SHELL WHITE
(PAINTED)



PEBBLE GREY
(PAINTED)



NEW NAUTICAL BLUE*
(PAINTED)



NEW SAGE GREEN*
(PAINTED)



SANDSTONE
(STAINED)



SLATE
(STAINED)



ESPRESSO
(STAINED)

MAUI FINISHES



POLAR WHITE
(PAINTED)



SLATE
(STAINED)



HATTERAS FINISHES



POLAR WHITE
(PAINTED)



PEBBLE GREY
(PAINTED)



SLATE
(STAINED)



ESPRESSO
(STAINED)

DOOR STYLES

CATALINA

Premier Collection

More than modern.
The Catalina door style features a full-overlay, Shaker style door and 5-piece drawer front.



Pebble Grey

MAUI

Premier Collection

Sometimes the details make all the difference. The Maui door style features a full-overlay, transitional door and 5-piece drawer front with a twist of character.



Polar White

HATTERAS

Essentials Collection

Simple and sleek.
The Hatteras door style features
a partial-overlay, Shaker style
door and slab drawer front.

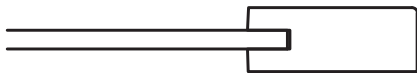

Pebble Grey

Catalina
in stained
Espresso

Maui
in painted
Polar White

Catalina
in stained
Sandstone

Maui
in stained
Slate

Hatteras
in painted
Pebble Grey

PREMIER COLLECTION: CATALINA



CATALINA

POLAR WHITE FINISH

*Island cabinets shown
in Catalina Espresso*

**NORTH
POINT**
CABINETS[®]



Decorative Cabinet Hardware: Hadly Collection in Matte Black



PREMIER COLLECTION: CATALINA



CATALINA

SHELL WHITE
FINISH

*Island cabinets shown
in Catalina Sandstone*

**NORTH
POINT**
CABINETS[®]



Decorative Cabinet Hardware: Audrey Collection in Satin Nickel



PREMIER COLLECTION: CATALINA



CATALINA

PEBBLE GREY
FINISH

**NORTH
POINT**
CABINETS®





PREMIER COLLECTION: CATALINA



CATALINA

NAUTICAL
BLUE
FINISH*

*Perimeter cabinets shown
in Catalina Polar White*

**Curated selection*

**NORTH
POINT**
CABINETS[®]



Decorative Cabinet Hardware: Griffin Collection in Satin Bronze



PREMIER COLLECTION: CATALINA



CATALINA

SAGE GREEN
FINISH*

*Perimeter cabinets shown
in Catalina Sandstone*

**Curated selection*

**NORTH
POINT**
CABINETS[®]



Decorative Cabinet Hardware: Ivan Collection in Matte Black



PREMIER COLLECTION: CATALINA



CATALINA

SANDSTONE FINISH

*Island cabinets shown
in Catalina Polar White*

**NORTH
POINT**
CABINETS[®]



Decorative Cabinet Hardware: Sullivan Collection in Matte Black



PREMIER COLLECTION: CATALINA



CATALINA

SLATE
FINISH

*Island cabinets shown
in Catalina Polar White*

**NORTH
POINT**
CABINETS[®]



Decorative Cabinet Hardware: Dominique Collection in Matte Black



PREMIER COLLECTION: CATALINA



CATALINA

ESPRESSO FINISH

*Perimeter cabinets shown
in Catalina Polar White*

**NORTH
POINT**
CABINETRY®



Decorative Cabinet Hardware: William Collection in Satin Nickel



PREMIER COLLECTION: MAUI



MAUI

POLAR WHITE FINISH

*Island cabinets shown
in Maui Slate*

**NORTH
POINT**
CABINETS[®]



Decorative Cabinet Hardware: Griffin Collection in Matte Black



PREMIER COLLECTION: MAUI



MAUI

SLATE FINISH

*Island cabinets shown
in Maui Polar White*

**NORTH
POINT**
CABINETS[®]



Decorative Cabinet Hardware: Belcastel 1 Collection in Matte Black



ESSENTIALS COLLECTION: HATTERAS



HATTERAS

POLAR WHITE FINISH

*Island cabinets shown
in Hatteras Pebble Grey*

**NORTH
POINT**
CABINETS®



Decorative Cabinet Hardware: Naples Collection in Brushed Gold



ESSENTIALS COLLECTION: HATTERAS



HATTERAS

PEBBLE GREY
FINISH



**NORTH
POINT**
CABINETS®

Decorative Cabinet Hardware: Gibson Collection in Matte Black



ESSENTIALS COLLECTION: HATTERAS



HATTERAS

SLATE
FINISH

**NORTH
POINT**
CABINETS®



Decorative Cabinet Hardware: William Collection in Satin Nickel



ESSENTIALS COLLECTION: HATTERAS



HATTERAS

ESPRESSO
FINISH

**NORTH
POINT**
CABINETS®



Decorative Cabinet Hardware: Sutton Collection in Polished Chrome



Versatile Vanity Cabinets

Our kitchen and vanity cabinets are made with the same dependable quality and construction. The vanity door styles and finishes match our kitchen cabinet collections, which allows you to design coordinated spaces and create an intelligent design flow from kitchen to bathroom. Mix up the design styles and finishes from room to room if that best fits the design personality.

We offer many different vanity cabinet configurations that allow our cabinets to perfectly fit most bathroom spaces. Options like linen cabinets and all-drawer cabinets go the extra mile to make the bathroom space functional and beautiful.



Catalina Polar White Cabinets

Decorative Cabinet Hardware: Tahoe Collection in Black

Create the Perfect Vanity

Our cabinets are designed to mix and match for a customized solution to fit your lifestyle. Need more drawers? No problem. Prefer one sink and lots of counter space? We've got you covered. Here are some popular combinations to get you started designing the perfect vanity for your project.

36" Overall Width

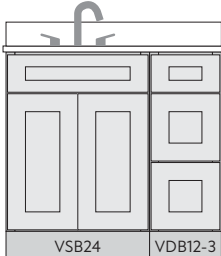

42" Overall Width

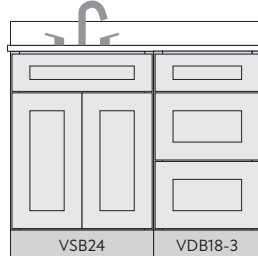

42" Overall Width

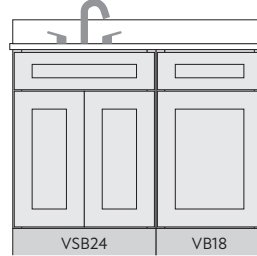

48" Overall Width

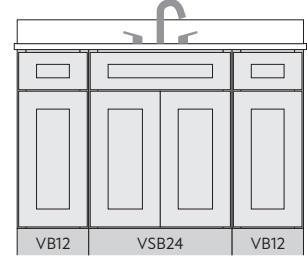

54" Overall Width

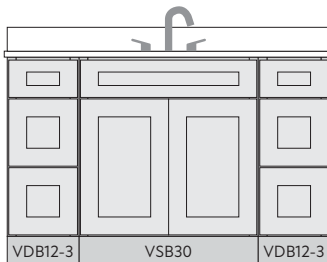

54" Overall Width

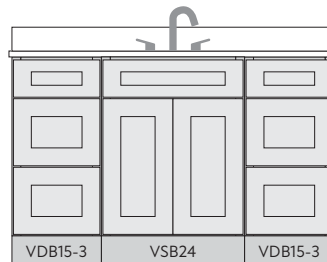

54" Overall Width

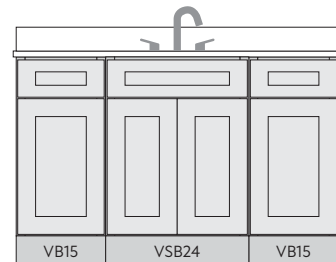

66" Overall Width

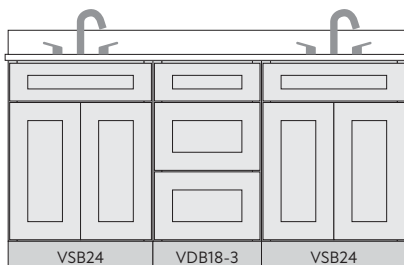

66" Overall Width

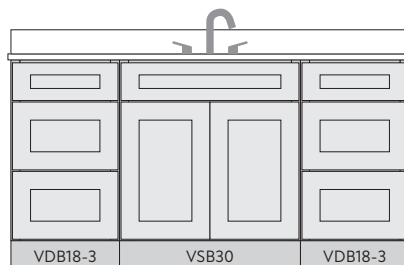

66" Overall Width

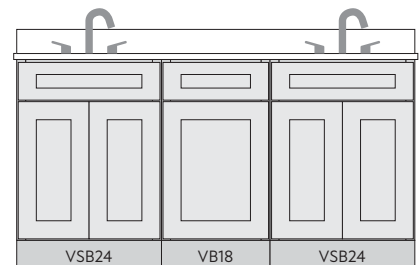

72" Overall Width

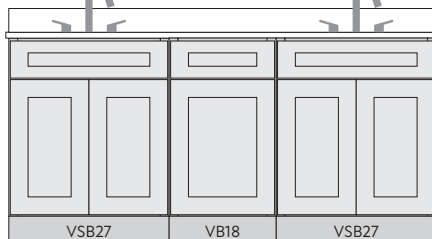

75" Overall Width

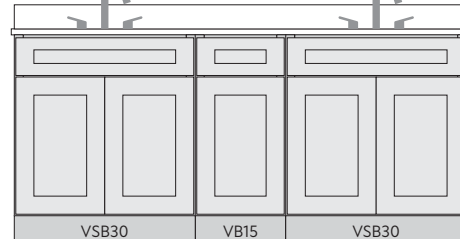

81" Overall Width

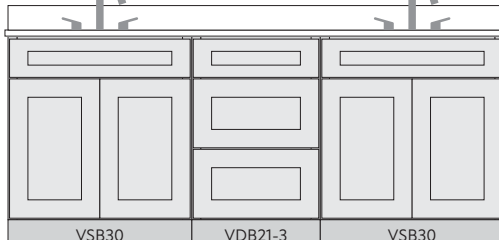

84" Overall Width

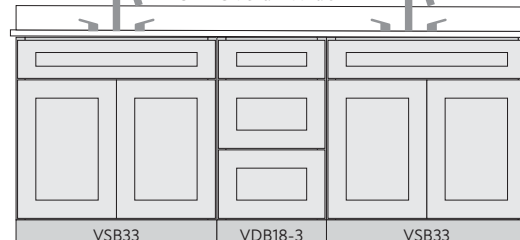



Catalina Sandstone Cabinets
Decorative Cabinet Hardware:
Tiffany in Satin Bronze



Catalina Slate Cabinets
Decorative Cabinet Hardware: Larkin in Matte Black with Brushed Gold



Hatteras Polar White Cabinets
Decorative Cabinet Hardware: Tiffany in Satin Nickel

Cabinets for Any Space

The kitchen and bath are common spaces to install cabinetry. However, NorthPoint Cabinetry provides solutions for other spaces like the laundry room, mudroom, and entertainment areas. Cabinets make those areas more functional by providing additional storage and countertop work space.



BEVERAGE BAR

Catalina Sandstone Cabinets

Decorative Cabinet Hardware: Roman Collection in Matte Black

MUDROOM

Maui Polar White
Cabinets

Decorative Cabinet
Hardware:
Ella Collection in
Brushed Oil Rubbed
Bronze



LAUNDRY ROOM

Catalina Slate Cabinets

Decorative Cabinet
Hardware:
Hudson Collection
in Satin Nickel



BUTLER'S PANTRY

Catalina Polar White Cabinets

Decorative Cabinet Hardware:
Wheeler Collection in Matte Black





CRAFT ROOM

Catalina Shell White Perimeter Cabinets and Catalina Sage Green Island Cabinets
Decorative Cabinet Hardware: Knox Collection in Satin Nickel



ENTERTAINMENT CENTER

Catalina Espresso Cabinets

Personalize Your Space - Moulding

Add the finishing touch to your cabinets with our broad selection of finished mouldings. Light rail moulding allows under-cabinet task lighting to be neatly tucked out of sight, while our selection of crown mouldings, from cove to classic, adds a level of beauty and sophistication to the room. We offer many different types of decorative and utility mouldings in all finishes to accentuate and complete the space.

LIGHT RAIL

Standard finishes available:
Espresso, Pebble Grey, Polar White,
Sandstone, Shell White, and Slate



FINISH MOULDINGS

Standard finishes available: Espresso, Pebble Grey, Polar White, Sandstone, Shell White, and Slate

Accent finishes available: Nautical Blue* and Sage Green*



CROWN MOULDINGS

Standard finishes available:
Espresso, Pebble Grey, Polar White,
Sandstone, Shell White, and Slate

Cove Crown Look



Angled Crown Look



Classic Crown Look



Personalize Your Space - Fillers & Panels

We offer a variety of fillers including standard, fluted, and overlay, as well as decorative end panels to help complete the cabinets with style. Create smooth transitions in cabinet layouts with fillers. Use decorative end panels to add character and a finish touch to your design. Utility panels, like refrigerator end panels, dishwasher end panels, and island back panels accommodate endless kitchen layouts. More options available. Ask your dealer to check our Specification Guide for complete offering.



FLUTED FILLER

3/4" Thick Material

Standard finishes available:
Espresso, Pebble Grey, Polar White,
Sandstone, Shell White, and Slate

BEADBOARD PANELS

1/4" Thick Material

Standard finishes available:
Espresso, Pebble Grey, Polar White,
Sandstone, Shell White, and Slate





WALL, BASE, & REFRIGERATOR END PANELS

Standard finishes available:
Espresso, Pebble Grey, Polar White,
Sandstone, Shell White, and Slate

Accent finishes available
in Base End Panels only:
Nautical Blue and Sage Green

DECORATIVE END PANELS

Available in all door styles

Standard finishes available:
Espresso, Pebble Grey, Polar White,
Sandstone, Shell White, and Slate

Accent finishes available in
Base Decorative End Panels only:
Nautical Blue and Sage Green



Personalize Your Space - Design Elements

Your cabinets should reflect your style. Our wide variety of decorative wood accessories adds a touch of character to the cabinet design. Whether your ideal space is traditional, transitional, or contemporary, we have the selection available to transform the space from “blah” to “ahhh!” More options available. Ask your dealer to check our Specification Guide for complete offering.



CORBELS

Standard finishes available:
Espresso, Pebble Grey, Polar White,
Sandstone, Shell White, and Slate



DECORATIVE LEGS

Standard finishes available:
Espresso, Pebble Grey,
Polar White, Sandstone,
Shell White, and Slate





BUN & TAPERED FEET

Standard finishes available:
Espresso, Pebble Grey, Polar White,
Sandstone, Shell White, and Slate



SCALLOPED OR ARCHED VALANCE

Standard finishes available:
Espresso, Pebble Grey, Polar White,
Sandstone, Shell White, and Slate



Personalize Your Space - Specialty Cabinets

Our wide selection of specialty cabinets expands the functionality to fit your lifestyle. Whether you need an elegant storage solution for your bottles of wine or want a space to display your trendy decorative plates, we have the solutions that work for you. More options available.

Ask your dealer to check our Specification Guide for complete offering.



Wine Rack



Plate Rack



Microwave Wall Cabinet



Microwave Base Cabinet



Catalina Pebble Grey Cabinets

Decorative Cabinet Hardware: Marlo in Satin Nickel



RANGE HOODS

Standard finishes available:
Espresso, Pebble Grey, Polar White,
Sandstone, and Slate

FARMHOUSE SINK BASE CABINET

Available in all door styles

Standard finishes available:
Espresso, Pebble Grey, Polar White,
Sandstone, Shell White, and Slate



GLASS DOOR CABINETS

Only available in the Premier collection
door styles, Catalina & Maui

Standard finishes available:
Espresso, Pebble Grey, Polar White,
Sandstone, Shell White, and Slate

Cabinets come with matching interiors
and a clear glass center panel

THE FINISHING TOUCHES

KNOBS & PULLS • ORGANIZERS
CABINET LIGHTING • HIDDEN POWER • SINKS





Catalina Polar White Cabinets
Decorative Cabinet Hardware: Hadly Collection in Matte Black 57

Knobs & Pulls

JEFFREY ALEXANDER®
by Hardware Resources

E L E M E N T S®
by Hardware Resources

Cabinets from NorthPoint Cabinetry are not complete without Jeffrey Alexander or Elements cabinet knobs and pulls! Your clients can personalize their space—really bringing their style to life. Cabinet knobs and pulls often take center stage by adding the finishing touch on the perfect design. There are thousands of different knobs and pulls to choose from in various sizes, finish options, and price points so that they can achieve that perfect look.

See our full offering of cabinet knobs & pulls at www.HardwareResources.com/decorative-hardware.



Matte Black Pulls

Jeffrey Alexander Sullivan Collection
Catalina Sandstone Cabinets



For more information on
Knobs & Pulls, scan the QR code
or visit <https://delivr.com/2fk7w>



Satin Bronze Pulls

Jeffrey Alexander Griffin Collection
Catalina Nautical Blue Cabinets



Satin Nickel Pulls

Jeffrey Alexander Merrick Collection
Catalina Pebble Grey Cabinets



Brushed Gold Pulls

Elements Naples Collection
Hatteras Polar White Cabinets

Popular Styles in Satin Nickel



Belcastel Collection



Boswell Collection



Dominique Collection



Florence Collection



Fontana Collection



Gibson Collection



Griffin Collection



Hadly Collection



Hayworth Collection



Jules Collection



Loxley Collection



Madison Collection



Naples Collection



Richard Collection



Roman Collection



Stanton Collection



Sullivan Collection



Sutton Collection



Thatcher Collection



Walker 1 & 2 Collection

Popular Styles in Matte Black



Belcastel Collection



Boswell Collection



Dominique Collection



Florence Collection



Fontana Collection



Gibson Collection



Griffin Collection



Hadly Collection



Hayworth Collection



Jules Collection



Loxley Collection



Madison Collection



Merrick Collection



Naples Collection



Richard Collection



Stanton Collection



Sullivan Collection



Sutton Collection



Thatcher Collection



Walker 1 & 2 Collection

To see more styles, lengths, and finishes, visit www.HardwareResources.com for more information.



**NORTH
POINT**
CABINETS®

Popular Styles in Satin Bronze



Belcastel Collection



Dominique Collection



Elara Collection



Florence Collection



Fontana Collection



Gibson Collection



Griffin Collection



Hayworth Collection



Jules Collection



Leyton Collection



Loxley Collection



Madison Collection



Naples Collection



Richard Collection



Stanton Collection



Sutton Collection



Thatcher Collection



Tiffany Collection



Walker 1 & 2 Collection



William Collection

Popular Styles in Brushed Gold



Dominique Collection



Gibson Collection



Hayworth Collection



Naples Collection



Richard Collection



Sutton Collection



Thatcher Collection



Walker 1 & 2 Collection

Popular Styles in Polished Chrome



Belcastel Collection



Boswell Collection



Dominique Collection



Florence Collection



Gibson Collection



Hayworth Collection



Merrick Collection



Milan 1 Collection



Naples Collection



Stanton Collection



Sullivan Collection



Sutton Collection

To see more styles, lengths, and finishes, visit www.HardwareResources.com for more information.



**NORTH
POINT**
CABINETS®

Long Cabinet Pulls Look Best

Cabinet knobs and pulls come in a variety of sizes, styles and finishes. But which ones should you choose?

You could decide to use all cabinet pulls. Or you may prefer the look of all cabinet knobs. Or you can mix knobs and pulls in your kitchen. Which one is right? They all are. All it comes down to is your personal preference.

Best Look

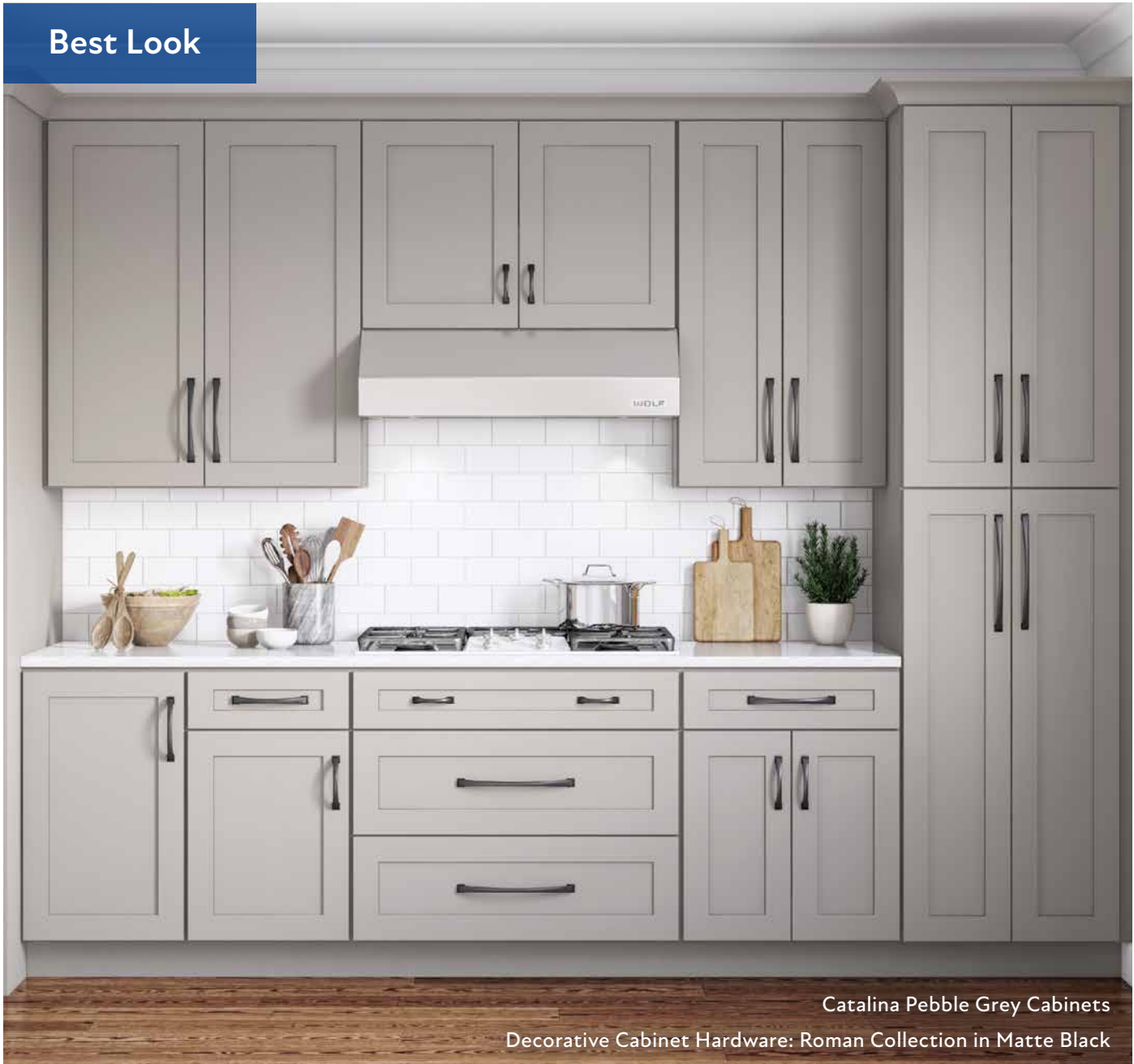

Catalina Pebble Grey Cabinets

Decorative Cabinet Hardware: Roman Collection in Matte Black

To achieve a cohesive & finished look, select a pull that's proportional in length to the cabinet door or drawer. Shorter doors & drawers use shorter pulls; longer doors & drawers use longer pulls.

Better Look



Catalina Pebble Grey Cabinets

Decorative Cabinet Hardware: Roman Collection in Matte Black

Good Look



Catalina Pebble Grey Cabinets

Decorative Cabinet Hardware: Roman Collection in Matte Black



For more information on
selecting knobs & pulls,
scan the QR code or visit
<https://delivr.com/2fk7w>

Create an Organized & Efficient Kitchen

Cabinet design is not only about aesthetics—functionality of the space is an important factor. Improve your client's experience with Organizers that conquer clutter and make reaching items easy and efficient. See our full offering of Organizer products at www.HardwareResources.com/organizers.

NEATLY TUCK AWAY TRASH CANS

Pick a trash can solution that best fits your kitchen and your budget.

- Wood Bottom Mount Trash Can
- Economy Soft-Close Trash Can
- Storage with Style® Trash Can Pullout

✓ POPULAR



✓ POPULAR



ORGANIZATION WITHIN REACH

Maximize cabinet storage with base cabinet organizers. Choose pullout organizers to maximize storage and eliminate the reach.

- "No Wiggle" Base Pullout
- "No Wiggle" Utensil Pullout
- "No Wiggle" Knife Pullout



For more information on cabinet organizers, scan the QR code or visit <https://delivr.com/272ju>



CORNER STORAGE THAT COMES TO YOU

Bring the deep recesses of corner cabinets forward with corner organizers.

- CornerMax™ Lazy Susan
- Easy 360 Susan
- Half-moon Lazy Susan

TAME DRAWER CLUTTER

Drawer inserts help organize everything from cutlery to spices to dishes.

- SlimLine Cutlery Drawer Insert
- Spice Rack Drawer Insert
- Coffee Pod Drawer Insert

✓ POPULAR



ORGANIZE HEAVILY USED CABINETS

Go from disorder to order with solutions for challenging storage areas.

- Easy Access Pantry Pullout
- Double Drawer Bottle Rollout
- Mixer Lift

Ask your dealer to check the NorthPoint Cabinetry Specification Guide to determine which organizers fit in each cabinet.

Organize Your Whole Kitchen





 For more information on cabinet organizers, scan the QR code or visit <https://delivr.com/272ju>

**NORTH
POINT**
CABINETS[®]

Organization Is Not Just for the Kitchen

An organized bathroom is just as important as an organized kitchen. Getting ready for the day in an organized bathroom helps to eliminate stress and save time. These organizers will help transform any bathroom into a dream spa oasis.



Catalina Slate Cabinets
Decorative Cabinet Hardware: Walker 1 Collection in Satin Bronze



1 Vanity Depth Drawer Insert

Organize a variety of beauty and grooming items in bathroom drawers with this clever insert that is adjustable and trimmable for a variety of drawer sizes.

*Fits in 12" wide cabinets or larger
May require trimming*



2 Vanity Depth Wood Bottom Mount Trash Can

Tuck bathroom trash cans away from little hands or wandering noses with this pullout, designed for mounted-door or hinged-door applications.

Fits in 15" wide cabinets



3 "No Wiggle" Vanity Pullout

Bring "no wiggle" technology into the bathroom and tame clutter with a pullout designed with the bath in mind. With two optional inserts available, this product can be modified to suit a variety of needs.

Fits in 12" wide cabinets



POWER AT YOUR FINGERTIPS

Tame vanity countertop cord and device clutter with in-drawer power outlets and charging ports. Choose powered bathroom organizers to add glamour and convenience to every bathroom suite.

- “No Wiggle” Powered Vanity Pullout
- Powered Vanity Drawer
- Vanity Charging Drawer



ROLLOUTS PROVIDE CLEVER STORAGE SOLUTIONS

Perfect for cleaning supplies, towels, and toiletries, these rollout organizers help customers easily access hard-to-reach storage areas.

- U-Shaped Rollout
- Wire Cleaning Supply Caddy
- Wire Basket Rollout



For more information on cabinet organizers, scan the QR code or visit <https://delivr.com/272ju>

Ask your dealer to check the NorthPoint Cabinetry Specification Guide to determine which organizers fit in each cabinet.

Everything and the Kitchen Sink

The sink is an often-overlooked focal point in the home. Not only does a sink need to hold up against everyday life, but it should also add a look of sophistication and elegance to a room.

Hardware Resources is proud to offer a line of Stainless Steel Kitchen, Bar, and Utility sinks for the everyday home. We offer a variety of sizes and styles of sinks, all manufactured from the highest quality materials. See our full offering of sinks at www.HardwareResources.com/sinks.



HA200

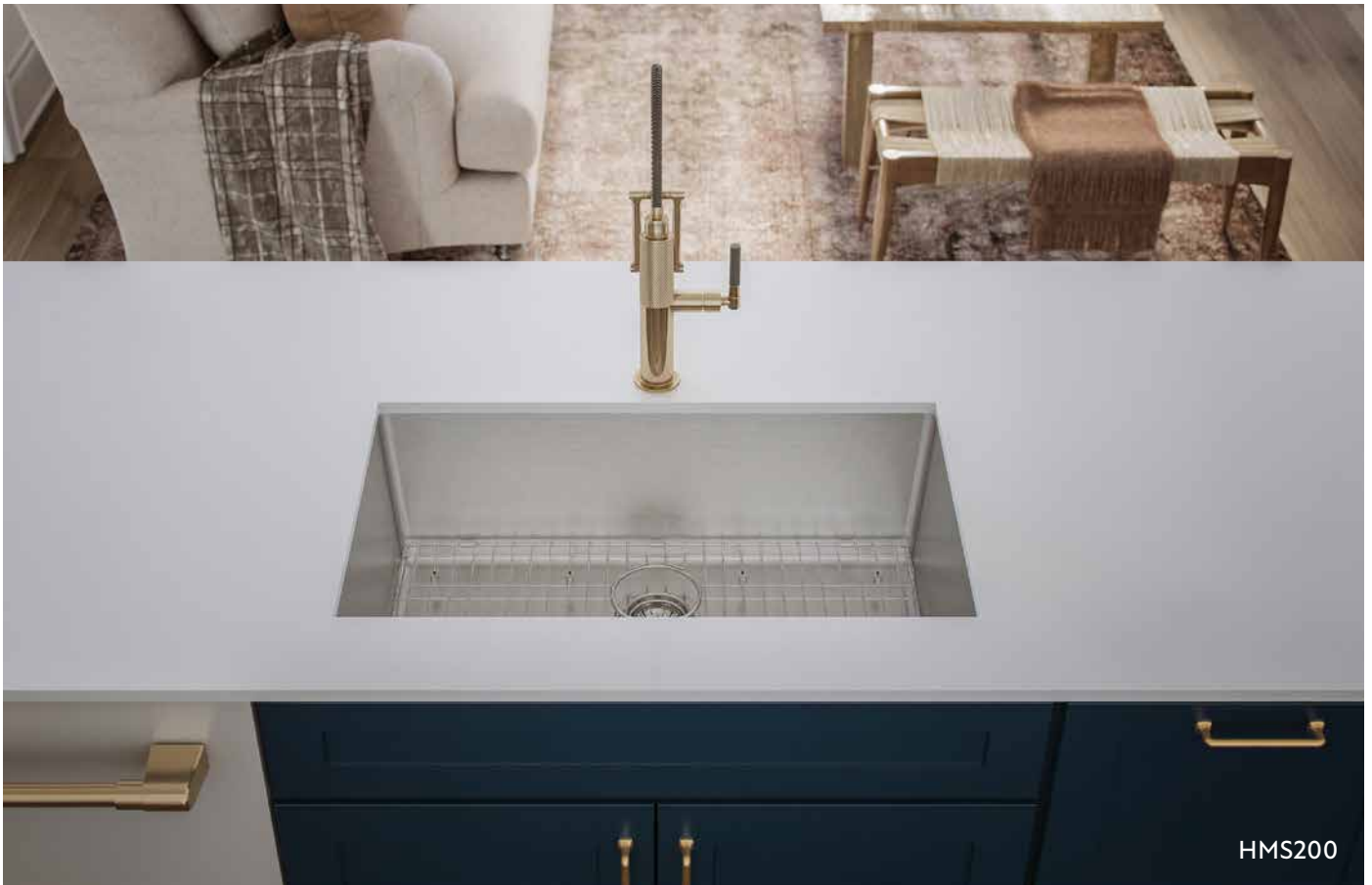

For more information
on stainless steel sinks,
scan the QR code or visit
<https://delivr.com/2qte5>

Add Lighting to Brighten the Kitchen



Highlight the beauty of your cabinet design with LED lighting from Task Lighting & Power®. Select from a variety of assembled linear fixtures, tape lighting, puck lights, and specialty lighting—allowing your clients to set the mood in any room.



Catalina Polar White & Slate Cabinets

1 ILLUMINATE COUNTERTOPS WITH UNDER CABINET LIGHTING

Illuminate countertops with under cabinet lighting to enhance functional spaces, highlight beautiful backsplashes, or eliminate shadows created from cabinets. Under cabinet lighting creates ample illumination for meal prep and reading recipes.

2 ACCENTUATE DECORATIVE ITEMS ON DISPLAY WITH IN CABINET LIGHTING

Use lighting in glass-faced cabinets to accentuate decorative items on display or highlight beautiful crystal and china. Adding lighting inside a glass door cabinet gives a nice wash of light throughout the cabinet.

3 HIGHLIGHT BEAUTIFUL FLOORING WITH TOE KICK LIGHTING

Add lighting under the toe kick to highlight beautiful flooring during the daytime. At night, keep floors safely illuminated with a gentle glow for midnight snacking.

4 ADD AMBIANCE AND MAKE THE SPACE FEEL LARGER WITH ABOVE CABINET LIGHTING

Add depth and ambiance to your kitchen by highlighting the open space above cabinets to increase the aesthetic appeal and make the space feel larger.

BEFORE

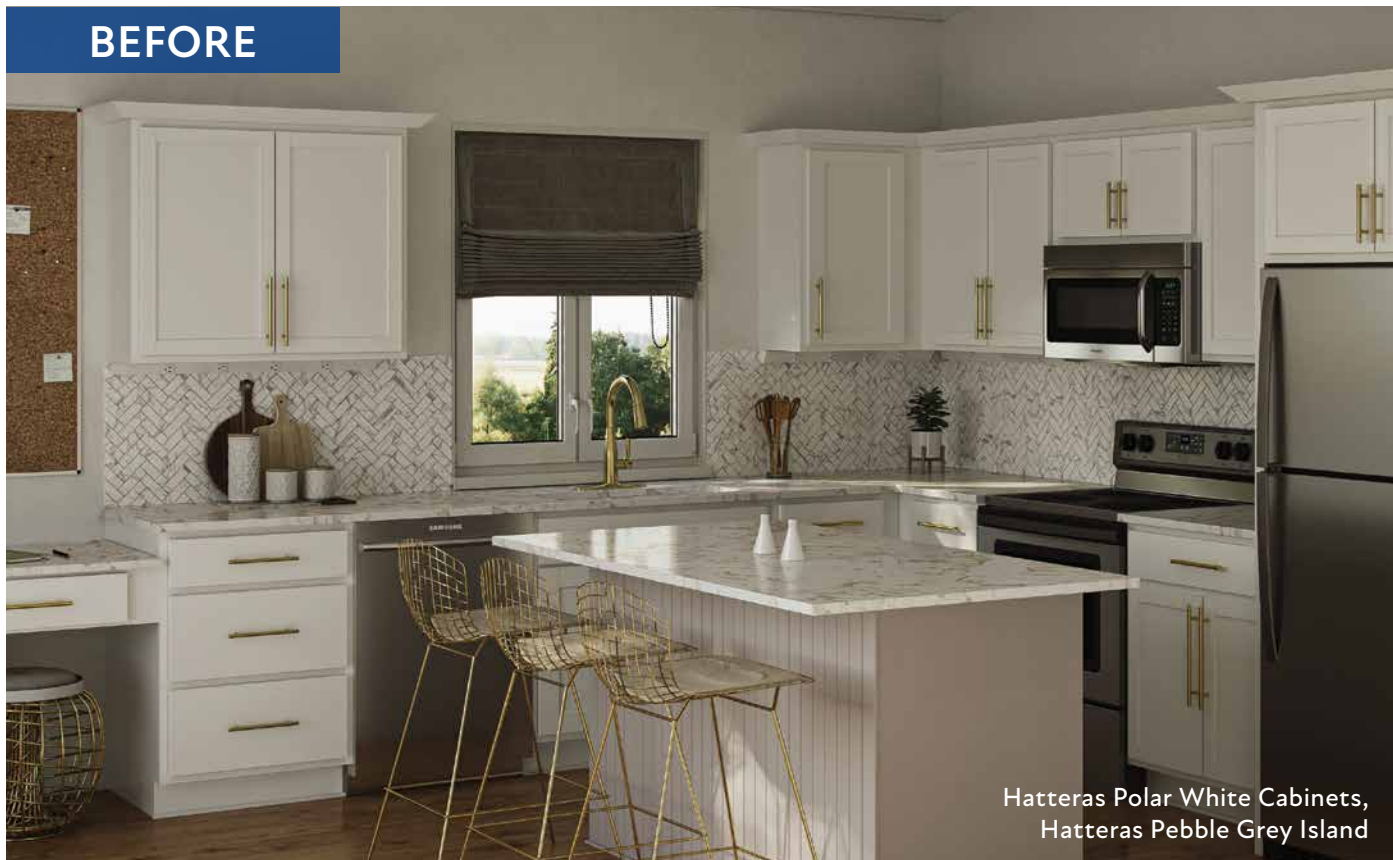

Hatteras Polar White Cabinets,
Hatteras Pebble Grey Island

AFTER

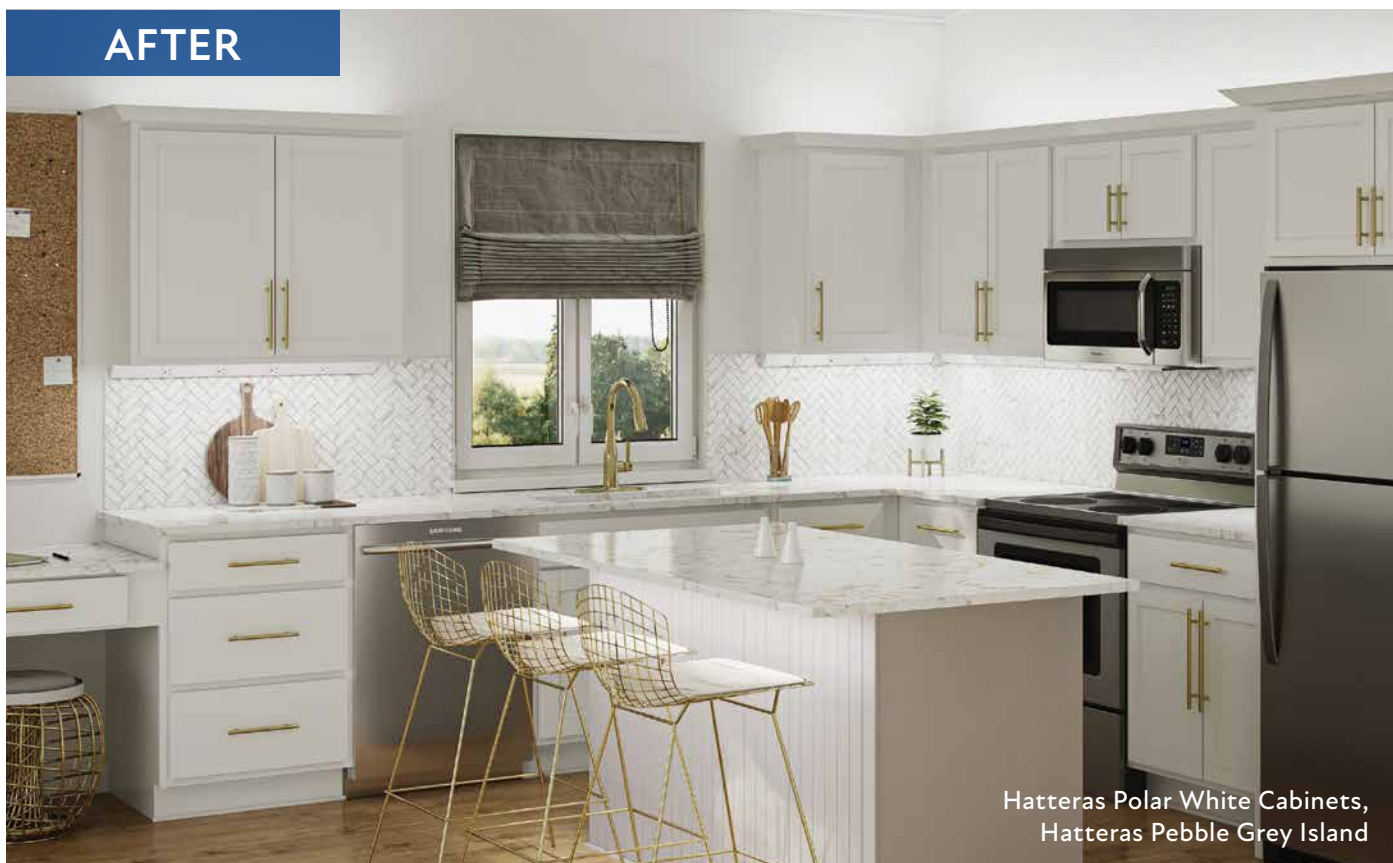

Hatteras Polar White Cabinets,
Hatteras Pebble Grey Island



For more information on Task Lighting products,
scan the QR code or visit <https://delivr.com/2eqnz>

Select the Perfect White Color Temperature for Lighting Any Space

When installing lighting, it's important to select an optimal white color (Kelvin) temperature that accentuates the beauty of the space. Pro tip: Using the same color temperature lighting throughout a room gives it a clean, even feel.



Or...Use Tunable White Lighting to Easily Change the White Color Temp Any Time!



Install tunable white lighting with patented TandemLED® technology to experience full tuning control of the white color temperature, from Warm White to Daylight White and all shades of white in between.



Using the wireless controller, adjust the white color temperature of tunable white lighting at any point throughout the day to match the natural lighting outside. A routine can also be set up in a Smart Home system's app to mimic the natural outdoor lighting throughout the day automatically.



.....
○ "Alexa, tune the kitchen to Warm White"

OPTION: Control lights with Amazon Alexa, Google Home, Philips Hue, Apple HomeKit, or any Zigbee 3.0 compatible system.

amazon alexa® Apple HomeKit Google Home zigbee® 3.0 devices

Zigbee is a trademark of Zigbee Alliance, Davis, California. Alexa is a trademark of Amazon, Seattle, Washington. Google Home is a trademark of Googleplex, Mountain View, California. HomeKit is a trademark of Apple, Cupertino, California. These marks are not affiliated with nor approved endorsements of Task Lighting & Power.



For more information on tunable white lighting products, scan the QR code or visit <https://delivr.com/2eqnz>



PATENT
10,721,801



Hide Unsightly Power Outlets



Angle Power Strip fixtures tuck away hidden power right where it's needed and are the perfect alternative to standard outlets that disrupt the beauty of glass, tile, or solid-surface backsplashes.



18" Black fixture*



18" Satin Nickel fixture*



18" Bronze fixture*



18" White fixture*

ASSEMBLED
IN THE USA

cUL US LISTED

5 YEAR WARRANTY



For more information on Angle Power Strip fixtures, scan the QR code or visit www.TaskLighting.com

**Available in standard lengths from 9" to 72", custom options available*



Tucked away electrical power, plus switches to control lighting, garbage disposal

Lighted Power Strip Combines LED lighting and angled power outlets

ASSEMBLED IN THE USA

Hatteras Polar White Cabinets, Hatteras Pebble Grey Island
Decorative Cabinet Hardware: Naples Collection in Brushed Gold

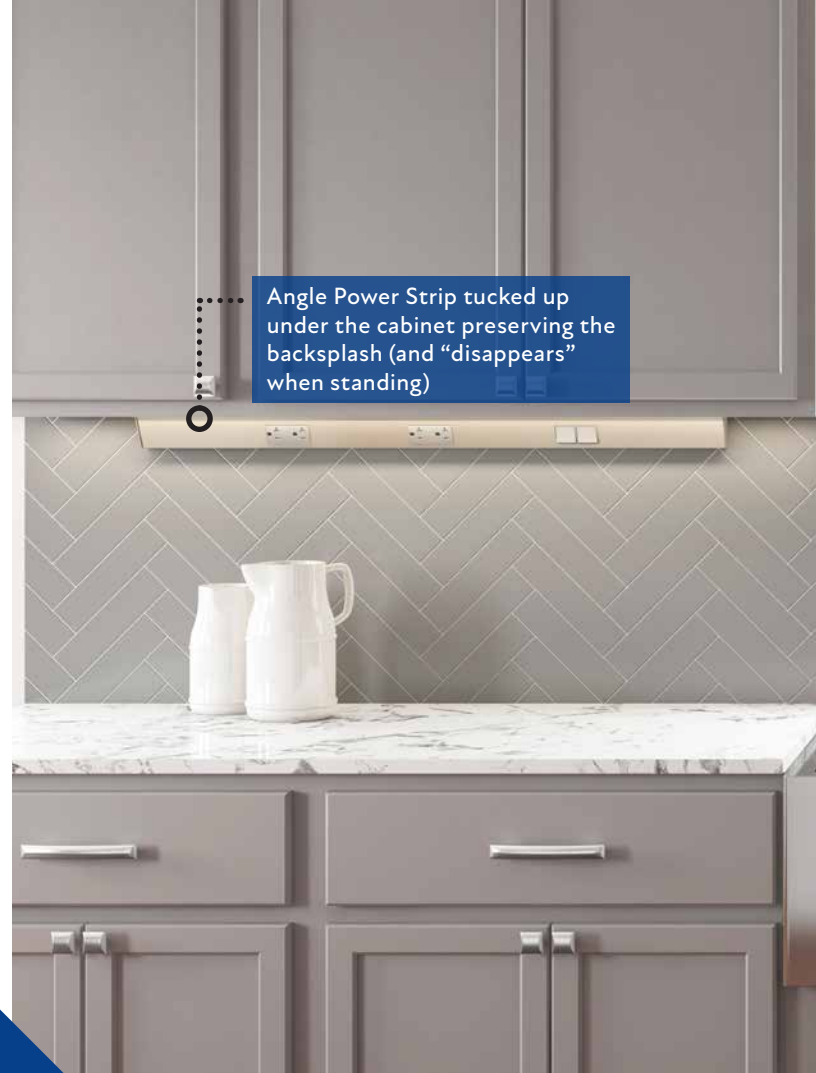

Angle Power Strip tucked up under the cabinet preserving the backsplash (and “disappears” when standing)

ELIMINATE THOSE UNSIGHTLY POWER OUTLETS WITH SLEEK, HIDDEN ANGLE POWER STRIP FIXTURES



Light & Power come together, out of sight beneath cabinets, with Lighted Power Strip fixtures. Now available with tunable-white lighting!

Lighted Power Strip tuned to Warm White 2700K



For more information on Angle Power Strip Fixtures, see the Task Lighting & Power Technical Catalog.

Lighted Power Strip tuned to Daylight White 5000K

Thoughtfully Designed. Carefully Crafted.

DOOR STYLES	PREMIER Collection Catalina, Maui	ESSENTIALS Collection Hatteras
A OVERLAY	<ul style="list-style-type: none"> • Full-overlay doors and drawer fronts 	<ul style="list-style-type: none"> • Partial-overlay doors and drawer fronts
B FACE FRAME	<ul style="list-style-type: none"> • 3/4" x 1-1/2" hardwood face frame 	<ul style="list-style-type: none"> • 3/4" x 1-1/2" hardwood face frame
C DOORS	<ul style="list-style-type: none"> • Stained (and Maui painted) doors are 5-piece solid wood cope-and-stick construction with a 3/4" thick, 2-3/4" wide door frame and 1/4" veneered center panel • Painted (except Maui) doors are 5-piece HDF cope-and-stick with a 3/4" thick, 2-3/4" wide door frame with 1/4" HDF center panel 	<ul style="list-style-type: none"> • Stained doors are 5-piece solid wood cope-and-stick construction with a 3/4" thick, 2" wide door frame and 1/4" veneered center panel • Painted doors are 5-piece HDF cope-and-stick with a 3/4" thick, 2" wide door frame and 1/4" HDF center panel
D HINGES	<ul style="list-style-type: none"> • 6-way adjustable soft-close concealed hinges 	<ul style="list-style-type: none"> • 6-way adjustable self-close concealed hinges
E DRAWER FRONTS	<ul style="list-style-type: none"> • 5-piece drawer fronts with 3/4" thick frame and 1/4" thick center panel 	<ul style="list-style-type: none"> • 3/4" thick slab drawer fronts
F DRAWERS	<ul style="list-style-type: none"> • 5/8" thick solid wood dovetail drawer boxes with 1/2" thick veneered plywood drawer bottom 	<ul style="list-style-type: none"> • 5/8" thick solid wood dovetail drawer boxes with 1/2" thick veneered plywood drawer bottom
G DRAWER SLIDES	<ul style="list-style-type: none"> • Premium full extension, 100 lb dynamic weight rated, adjustable undermount soft-close slides 	<ul style="list-style-type: none"> • 3/4 extension, 100 lb static weight rated, undermount epoxy slides
H SHELVES	<ul style="list-style-type: none"> • 3/4" thick veneered plywood adjustable shelves – half depth in base cabinets • 5 mm spoon pins included 	<ul style="list-style-type: none"> • 3/4" thick veneered plywood adjustable shelves – half depth in base cabinets • 5 mm spoon pins included
I END PANELS	<ul style="list-style-type: none"> • 1/2" thick plywood end panels with exterior finished to match • UV coated, natural birch interior 	<ul style="list-style-type: none"> • 1/2" thick plywood end panels with exterior finished to match • UV coated, natural birch interior
J TOP/BOTTOM PANELS	<ul style="list-style-type: none"> • 1/2" thick plywood captured top and bottom • UV coated, natural birch interior 	<ul style="list-style-type: none"> • 1/2" thick plywood captured top and bottom • UV coated, natural birch interior
K BACK PANELS	<ul style="list-style-type: none"> • UV coated plywood back panel 	<ul style="list-style-type: none"> • UV coated plywood back panel
L CONSTRUCTION	<ul style="list-style-type: none"> • All plywood cabinet construction • QuickBuild® Dovetail / Pocket screw assembly system • 3/4" thick solid wood corner braces • 4-1/2" high toe kick 	<ul style="list-style-type: none"> • All plywood cabinet construction • QuickBuild® Dovetail / Pocket screw assembly system • 3/4" thick solid wood corner braces • 4-1/2" high toe kick



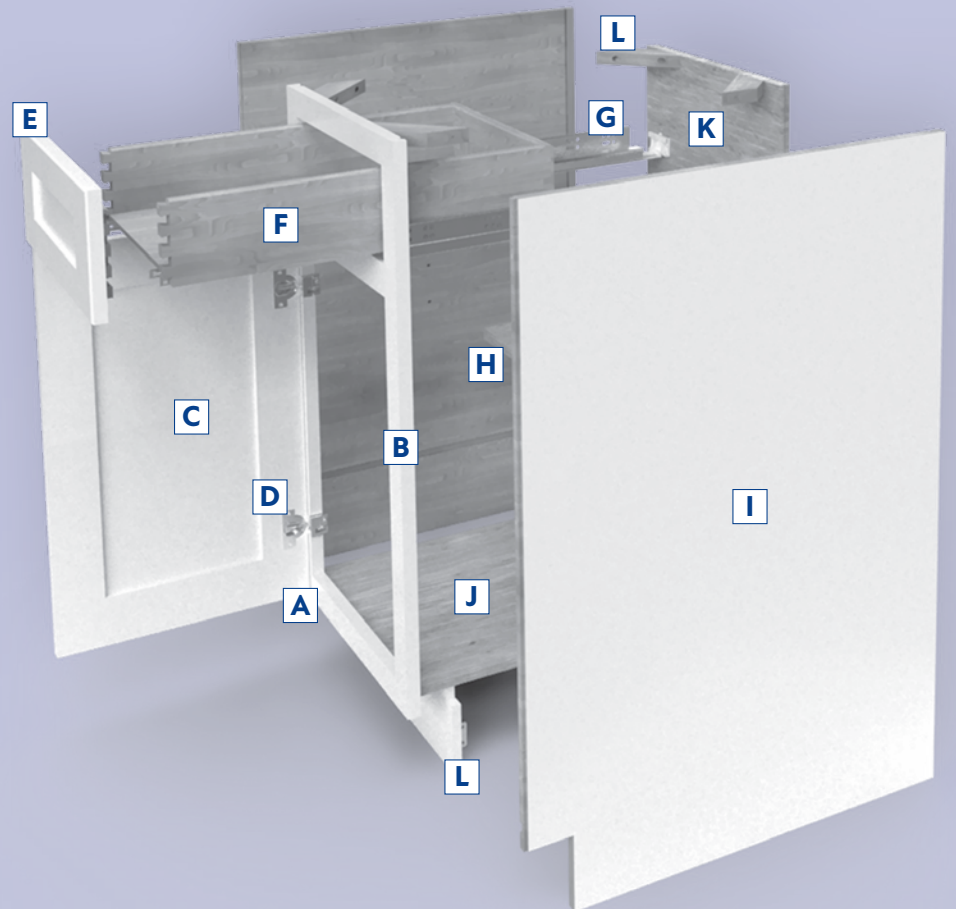
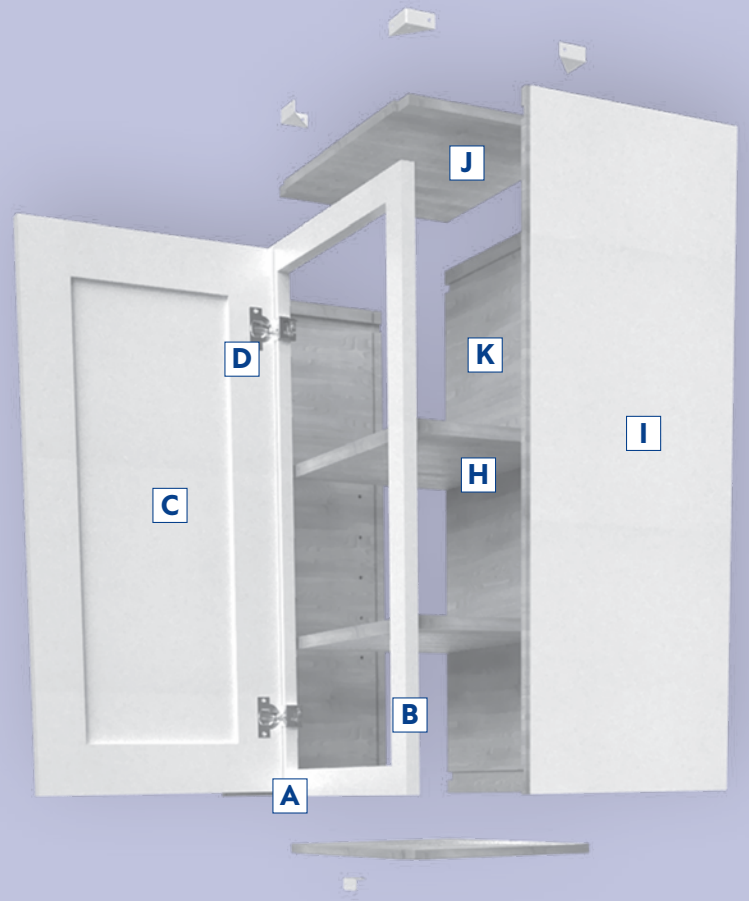

The Cabinet Lineup

WALL CABINETS

12" deep except where noted
 42" high wall cabinets will have 3 shelves
 *39" and 42" widths will have a center stile unless otherwise noted



Double Door
 12" Height
 30", 33", 36"
 or *39" Width



Double Door
 15" Height
 30", 33", 36"
 or *39" Width



Double Door
 18" Height
 21", 24", 30", 33", 36"
 or *39" Width



Double Door
 24" Height
 30", 33", 36" or *39" Width



Deep Double Door
 18" or 24" Height • 24" Depth
 36" or *39" Width
 18" Height does not have shelf



Single Door
 30" Height
 9", 12", 15", 18" or 21" Width



Double Door
 30" Height
 24", 27", 30", 33",
 36", *39" or *42" Width



Single Door
 36" Height
 9", 12", 15", 18" or 21" Width



Double Door
 36" Height
 24", 27", 30", 33",
 36", *39" or *42" Width



Single Door
 42" Height
 9", 12", 15", 18" or 21" Width



Double Door
 42" Height
 24", 27", 30", 33",
 36", *39" or *42"
 Width



Single & Double Glass Door
 Matching Interior
 30" Height
 15", 18", 30" or 36" Width



Single & Double Glass Door
 Matching Interior
 36" Height
 15", 18", 30" or 36" Width



Single & Double Glass Door
 Matching Interior
 42" Height
 15", 18", 30" or 36" Width



Wall End Single Door
 30", 36" or 42" Height
 12" Width

Glass door wall cabinets only available in the Premier collection



Diagonal Corner
 30", 36" or 42" Height
 12 or 15" Depth
 24" and 27" Width



Diagonal Corner Glass Door
 Matching Interior
 30", 36" or 42" Height
 12 or 15" Depth
 24" and 27" Width

Glass door wall cabinets only available in the Premier collection



Universal Blind Corner
 30", 36" or 42" Height
 30"-33" Width



Microwave Wall Cabinet
 Extended Shelf
 36" Height
 30" Width



Microwave Wall Cabinet
 Extended Shelf
 18" Height
 30" Width

BASE CABINETS

24" deep, 34-1/2" high
 except where noted

*39" and 42" widths
 will have a center stile
 unless otherwise noted



**Full Height
 Single Door**
 9", 12", 15" or 18" Width



**Single Door
 and Drawer**
 12", 15", 18" or 21" Width



**Double Door and
 Single Drawer**
 24", 27" or 30" Width



**Double Door and
 Double Drawer**
 33", 36", *39" or *42" Width



Double Drawer
30" or 36" Width



Triple Drawer
12", 15", 18", 21", 24", 30" or 36" Width



Base Corner Cabinet
33" or 36" Width
Lazy Susan inserts available



Universal Blind Base Corner
39"-42", 42"-45" or *45-48" Width



Microwave Base Cabinet with Drawer
30" Width

SINK BASE CABINETS

24" deep, 34-1/2" high except where noted.

*39" and 42" widths will have a center stile unless otherwise noted



Corner Sink Front Double Door
24" Depth
(2-piece bottom panel)



Sink Base Double Door
30", 33", 36" or 39" Width



Farmhouse Sink Base Double Door
36" or 39" Width
No center stile

TALL CABINETS

24" deep except where noted.



Utility/Pantry Single Door
84", 90" (6 shelves), or 96" Height (7 shelves)
18" Width



Utility/Pantry Double Door
84", 90" (6 shelves), or 96" Height (7 shelves)
24" or 30" Width



Universal Oven Double Door
84", 90" or *96" Height
33" Width



Oven Double Door, Single Drawer
84", 90" or *96" Height
33" Width
**Single shelf in 96" only
Double Oven Overlay Panel available*

VANITY CABINETS

21" deep, 34-1/2" high except where noted

*42" and 48" width Double Door cabinets will have a center stile



Single Door
12" Width



Single Door and Drawer
12", 15" or 18" Width



Double Door Sink Base*
24", 27", 30", 33", 36" or 42" Width



Sink Drawer Base
30" or 36" Width
Available in left or right drawer configuration



Triple Drawer
12", 15", 18" or 21" Width



Two Double Door Sink Base
48" Width



Double Door and Double Drawer Sink Base*
36", 42" or 48" Width



Double Door and Six Drawer Sink Base
60" Width



Two Double Door and Triple Drawer Sink Base
60" Width



Linen Single & Double Door
84" (6 shelves)
Single - 15" or 18" Width
Double - 24" Width



IS NORTHPOINT CABINETRY RIGHT FOR YOUR BUSINESS?

Do your projects have short timelines?

Want to grow your business without adding overhead?

Is the budget too tight for custom cabinets?

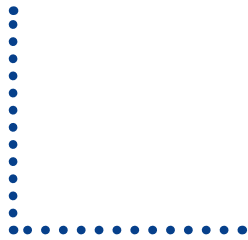

**NORTH
POINT**
CABINETS®

NorthPoint Cabinetry is a line of professional-grade, quick-assembly cabinets that helps your bottom line. Let us show you how!

What are QuickBuild® Cabinets?



Dovetail + Pocket Screws = QuickBuild®

Basic assembly of our cabinets is as simple as sliding the panels together and securing with pocket screws. You don't need extra fasteners to hold the panels in place, and conveniently placed pocket screws will reduce the average time you spend on each cabinet.

How fast can you build a cabinet?



One of our cabinets takes about 8 minutes* to assemble (many do it in 4). You can build a kitchen or bathroom in record time!



Scan the QR code to view our Quick Assembly Video.
<https://delivr.com/2kchw>

**Specialty cabinets may take longer than average to assemble.*



Resources

Website



Scan the QR code or visit
NorthPointCabinetry.com

Video



Scan the QR code or visit
<https://delivr.com/2z5tf>

Warranty



Scan the QR code or visit
<https://delivr.com/29q3j>



Catalina Nautical Blue Cabinets



Catalina Slate Cabinets



Catalina Sandstone Cabinets